

Master Worksheet T7P848 Rev 09

TAG®

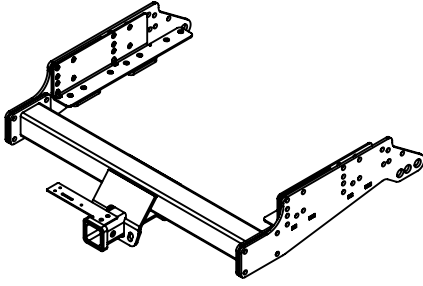

Notes:

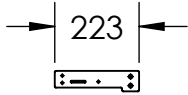

Description :
Top - Receiver Plug Bracket
Part No : 000-127 Rev : 03
Material : GR250 Plate Steel
Mass : 0.24kg Qty per : 1
Thickness : 3



Description :
Hitch Receiver Collar
Part No : 000-50 Rev : 05
Material : 75x75x5mm RHS C350L0
Mass : 0.15kg
Length : 14.00
Qty per : 1



Description :
Receiver 230 Long 40 hole
Part No : 000-61 Rev : 00
Material : RHS C350L0
Mass : 2.31kg
Length : 230
Qty per : 1

DOWN 40° R 10

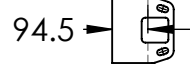

Description :
Receiver Support with
Chain Mount
Part No : 840-02 Rev : 03
Material : GR250 Plate Steel
Mass : 1.41kg Qty per : 1
Thickness : 8

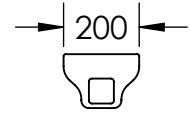

Description :
Receiver Backing Plate
Part No : 840-05 Rev : 00
Material : GR250 Plate Steel
Mass : 0.86kg Qty per : 1
Thickness : 6



Description :
Main Bar 75x75x4
Part No : 848-01 Rev : 00
Material : RHS C350L0
Mass : 7.25kg
Length : 844.00
Qty per : 1

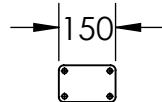

Description : End Cap
Part No : 848-03 Rev : 00
Material : GR250 Plate Steel
Mass : 0.89kg Qty per : 2
Thickness : 8

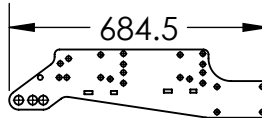

Description : Side Plate
Part No : 848-05 Rev : 06
Material : GR250 Plate Steel
Mass : 5.28kg Qty per : 2
Thickness : 8

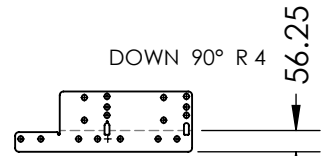

Description : Chassis Insert - PS
Part No : 848-06 Rev : 03
Material : GR250 Plate Steel
Mass : 1.88kg Qty per :
1PS + 1DS
Thickness : 4

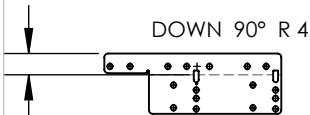

Description : Chassis Insert - DS
Part No : 848-06DS Rev : 03
Material : GR250 Plate Steel
Mass : 1.89kg Qty per :
1PS + 1DS
Thickness : 4

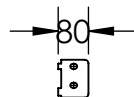

Description :
Horizontal Mounting Tab
Part No : 848-07 Rev : 00
Material : GR250 Plate Steel
Mass : 0.45kg Qty per : 4
Thickness : 8

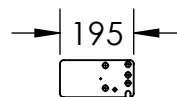

Description :
Chassis Extender Doubler
Part No : 848-09 Rev : 03
Material : GR250 Plate Steel
Mass : 0.58kg Qty per : 2
Thickness : 4

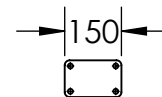

Description :
End Cap Spacer
Part No : 848-11 Rev : 00
Material : GR250 Plate Steel
Mass : 0.34kg Qty per : 2
Thickness : 3